

Cybozu[®] SP Apps

Installation Guide

First Edition

Cybozu, Inc.

Table of Contents

1. SP Apps Installation Guide	2
1.1 Installation Overview	2
1.2 How to Begin to Use SP Apps	3
1.3 Installing	3
1.4 Uninstalling	5

Introduction

This guide explains how to install “Cybozu SP Apps version 1.x” on SharePoint 2010.

Who Should Read This Guide

Administrators who are in charge of installing Cybozu SP Apps.

Production Environment

- OS: Windows Server 2008 Enterprise (English version)
- Web browser: Internet Explorer 8
- Product version: Cybozu SP Apps 1.0.0

Product Abbreviation

Product name	Abbreviation
Cybozu SP Apps	SP Apps
Cybozu SP List Scheduler	SP List Scheduler
Cybozu SP List Discussion	SP List Discussion
Microsoft SharePoint Server 2010	SharePoint Server 2010

Installation Overview

Once SP Apps is installed on SharePoint Server 2010, the following lists, site template, and style of SP Apps will be added to SharePoint Server 2010:

- SP List Scheduler list
SP List Scheduler is a collaboration tool that helps users manage events and helps event attendees communicate on a list. For the details on SP List Scheduler, see “SP List Scheduler Administrative Guide” and “SP List Scheduler Users Guide”.
- SP List Discussion list
SP List Discussion is a collaboration tool that allows users to create places to communicate with one another. For the details on SP List Discussion, see “SP List Discussion Administrative Guide” and “SP List Discussion Users Guide”.
- SP Apps style
You can apply the SP Apps style to the sites to use SP List Scheduler and SP List Discussion. For information on how to apply the style, see “Adding SP List Scheduler” in “SP List Scheduler Administrative Guide”, or “Adding SP List Discussion” in “SP List Discussion Administrative Guide”.
- SP Apps site template
You can create a site using this site template. The site that is created with this template has all the features of SP Apps, and the features are initially activated.

Web Applications Where SP Apps Is Installed

SP Apps is installed on the web applications of SharePoint Server 2010. You can use SP Apps on each site belonging to the web application where SP Apps is installed.

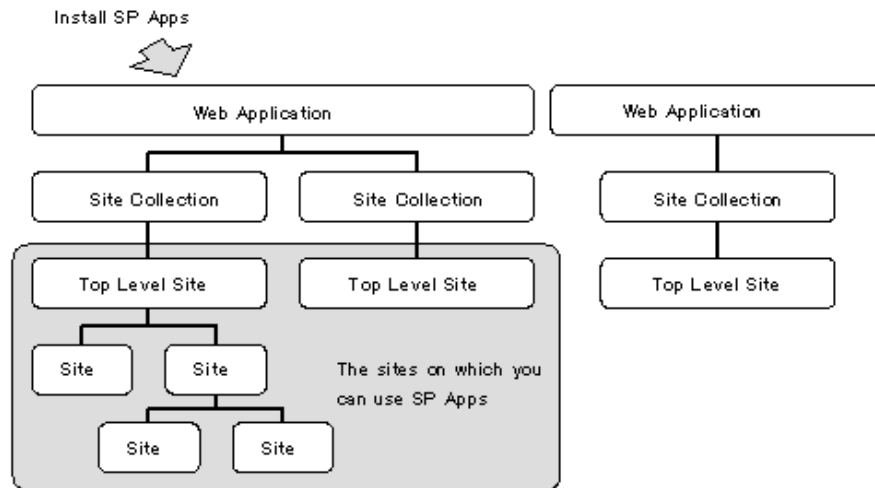

Tip
 The system requirements of SP Apps are compatible with SharePoint Server 2010. For the system requirements of SharePoint Server 2010, see the following web pages of Microsoft Corporation:
 Hardware and software requirements (SharePoint Server 2010)
<http://technet.microsoft.com/en-us/library/cc262485.aspx>
 Plan browser support (SharePoint Foundation 2010)
<http://technet.microsoft.com/en-us/library/cc288142.aspx>

How to Begin to Use SP Apps

This section explains how to begin to use SP Apps.

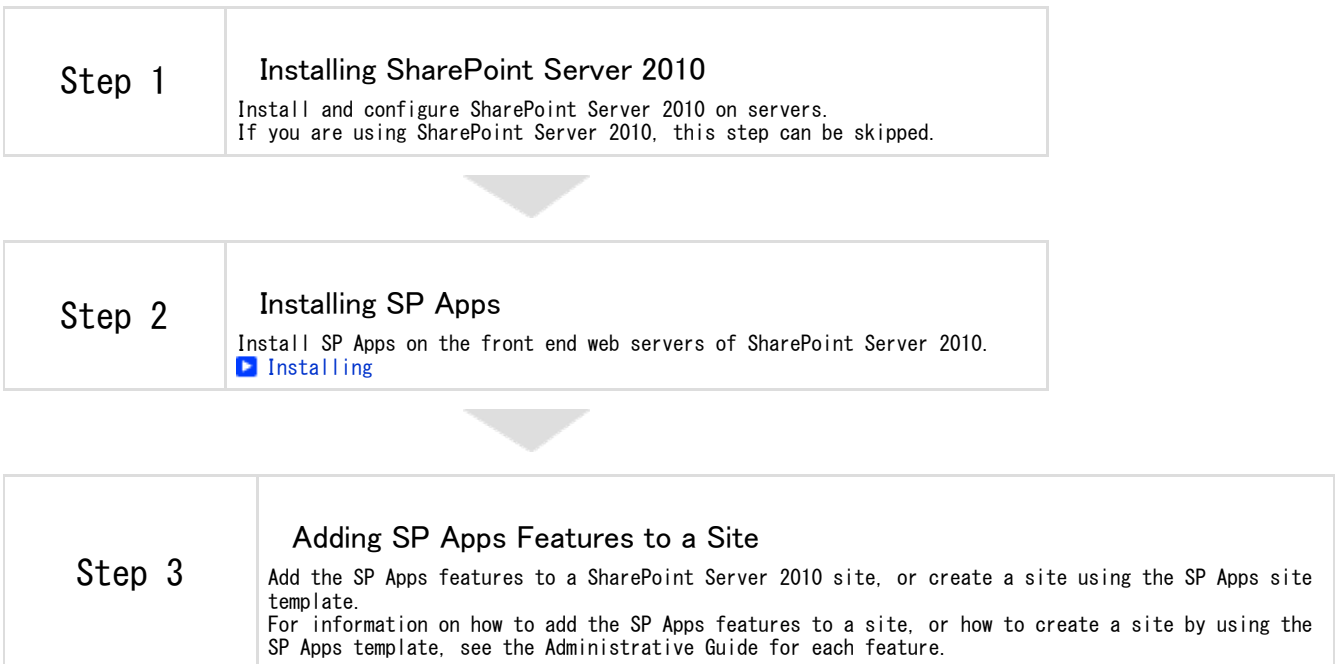

Installing

This section explains how to install SP Apps on SharePoint Server 2010. The section assumes that SP Apps is used on the sites that belong to "Web application A" on SharePoint Server 2010 of the following environment:

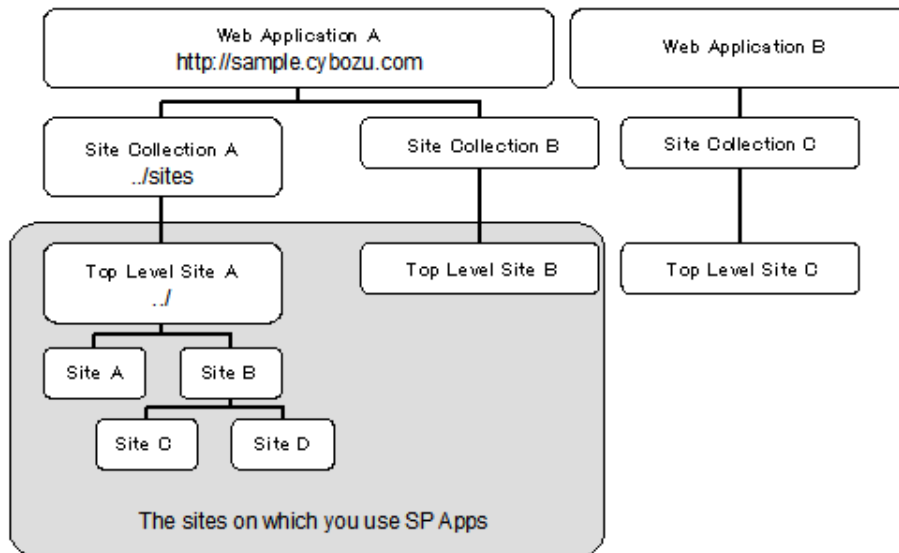

Tip

- You can download the latest archive of SP Apps from the following page:
 - <http://spapps.cybozu.com/jp/products/archive.html>
- Once you execute the installer, a log file "install.txt" is written in the folder where the installer exists.

- Log in to any of the front end web servers of SharePoint Server 2010. You must log in as a user who belongs to all of the following groups:
 - Administrator group
 - WSS_ADMIN_WPG group
- Extract the "cbspapps-1.0.0-sp2010-en" archive.
- Run Command Prompt. In case User Agent Control is enabled on Windows, Right click on the shortcut of Command Prompt and click **Run as administrator**. Command Prompt is ran as Administrator.
- Move to the decompressed folder at step 2.
- Run the following command:
SPApps1.0.0_EN.bat /url http://sample.cybozu.com/

In the "/url" parameter, enter the web application URL where you want to install SP Apps. Only one URL can be specified.
- Follow the instructions on the screen to start the installation. The installation is complete when the "Installation has completed" appears. To use SP Apps on two or more web applications, deploy the solutions on each web application.
 - [Using SP Apps on Two or More Web Applications](#)

Using SP Apps on Two or More Web Applications

To use SP Apps on two or more web applications, after installing SP Apps on one web application, deploy the solutions on each web application.

This section assumes that the SP Apps solutions are deployed on "Web application B". And assume that the URL of "Web application B" is http://sample.cybozu.com:11111/.

- On the top page of "Central Administration", click **System Settings**.
- Click **Manage farm solutions**.
- Click **cybozu.sharepoint.common.wsp**.
- Click **Deploy Solution** and set required items.

Items on the "Deploy Solution" screen

Item	Description
Solution Information	The information of the "cybozu.sharepoint.common.wsp" solution.
Deploy When?	Select "Now".
Deploy To?	Select a web application that uses SP Apps.

- Click **OK**. Confirm that the status of "cybozu.sharepoint.common.wsp" is "Deployed" on the "Solution Management" screen. If the status is not "Deployed", wait for a while and refresh the screen.
- For the other three solutions: "cybozu.sharepoint.discussion.wsp", "cybozu.sharepoint.license.manager.wsp", and "cybozu.sharepoint.scheduler.wsp", repeat the step 3 to 5.

7. On the "Deploy Solution" screen, click **cybozu.sharepoint.orionsite.wsp**.
8. Confirm that the "Globally deployed" is displayed in the "Deploy To?" field. If not, click **Deploy Solution** to deploy the solution to all desired web applications.
9. Run the following command:
`"C:\Program Files\Common Files\Microsoft Shared\Web Server Extensions\14\BIN\STSADM.EXE" -o updatealerttemplates -url http://sample.cybozu.com:11111/ -filename CybozuOrionalerttemplate.xml`

In the "-url" parameter, enter the URL of "Web application B". Only one URL can be specified.
Alert templates are updated.

10. Run the following command:
`timerJobInstaller.exe -install http://sample.cybozu.com:11111/`

In the "-install" parameter, enter the URL of "Web application B". Only one URL can be specified.
Timer job is installed.

11. Run the following command:
`net stop SPTimerV4`
`net start SPTimerV4`

SharePoint 2010 Timer is restarted.

Uninstalling

This section explains how to uninstall SP Apps from SharePoint Server 2010.
The procedures may vary depending on the web application that you want to uninstall SP Apps.

- [▶ Uninstalling SP Apps from a Specific Web Application](#)
- [▶ Uninstalling SP Apps from All Web Applications](#)

Uninstalling SP Apps from a Specific Web Application

This section assumes that SP Apps is uninstalled from "Web application A".
And assume that the URL of "Web application A" is <http://sample.cybozu.com/>.

Tip

- You can download the latest archive of SP Apps from the following page:
[▶ http://spapps.cybozu.com/us/products/index.html](http://spapps.cybozu.com/us/products/index.html)
- Once you execute the installer, a log file "install.txt" is written in the folder where the installer exists.

1. Remove SP Apps from all the sites of "Web application A".
 - SP List Scheduler and SP List Discussion.
 - Restore the site style to the standard style of SharePoint 2010.
 - Remove the web parts of SP Apps.
 After that, delete all web parts that belong to "Cybozu SP Apps" group from site collections.
2. Log in to any of the front end web servers of SharePoint Server 2010.
You must log in as a user who belongs to all of the following groups:
 - Administrator group
 - WSS_ADMIN_WPG group
3. Extract the "cbspapps-1.0.0-sp2010-en" archive.
4. Run Command Prompt.
In case User Agent Control is enabled on Windows, Right click on the shortcut of Command Prompt and click Run as administrator.
Command Prompt is ran as Administrator.
5. Move to the decompressed folder at step 3.
6. Run the following command:
`SPApps1.0.0_EN.bat /url http://sample.cybozu.com// /uninstall`

 In the "/url" parameter, enter the web application URL where you want to uninstall SP Apps. Only one URL can be specified.
7. Follow the instructions on the screen to start the uninstallation. The uninstallation is complete when the "The uninstallation has completed" appears.

Uninstalling SP Apps from All Web Applications

1. Remove SP Apps from all the sites of SharePoint Server 2010.
 - SP List Scheduler and SP List Discussion.
For information on how to remove SP List Scheduler and SP List Discussion from a site, see the Administrative Guide for each feature.
 - Restore the site style to the standard style of SharePoint 2010.
For information on how to restore the style, see the Administrative Guide for SP List Scheduler or SP List Discussion.
 - Remove the web parts of SP Apps.
2. On the top page of "Central Administration", click **System Settings**.
3. Click **Manage farm solutions**.
4. Click **cybozu.sharepoint.common.wsp**.

- Click **Retract Solution** and set required items.

Items on the "Retract Solution" screen

Item	Description
Solution Information	The information of the "cybozu.sharepoint.common.wsp" solution.
Retract When?	Select "Now".
Retract From?	Select the web application where you want to uninstall SP Apps. To uninstall SP Apps from all web applications, select "All content Web applications".

- Click **OK**.
- For the other three solutions: "cybozu.sharepoint.discussion.wsp", "cybozu.sharepoint.license.manager.wsp", and "cybozu.sharepoint.scheduler.wsp", repeat the step 4 to 6.
- On the "Solution Management" screen, click **cybozu.sharepoint.orionsite.wsp**.
- Click **Retract Solution**.
- Select "Now" on "Retract When?", and then click **OK**.
- On the "Solution Management", click **cybozu.sharepoint.common.wsp**.
- Click **Retract Solution** and set required items.

Items on the "Retract Solution" screen

Item	Description
Solution Information	The information of the "cybozu.sharepoint.common.wsp" solution.
Retract When?	Select "Now".
Retract From?	Select the "Central Administration" web application.

- Click **OK**.
- For the "cybozu.sharepoint.license.manager.wsp" solution, repeat the step 11 to 13.
- Run the following command:
`"C:\Program Files\Common Files\Microsoft Shared\Web Server Extensions\14\BIN\STSADM.EXE" -o updatealerttemplates -url http://sample.cybozu.com/`

Alert templates are initialized.

In the "-url" parameter, enter the URL of the web application where you want to remove SP Apps. Only one URL can be specified.

- Run the following command:
`timerJobInstaller.exe -uninstall http://sample.cybozu.com/`

Timer job is removed.

In the "-uninstall" parameter, enter the URL of the web application where you want to remove SP Apps. Only one URL can be specified.

- Repeat the step 15 to 16 for all other web applications.
- Run the following command:
`net stop SPTimerV4`
`net start SPTimerV4`

SharePoint 2010 Timer is restarted.